

## Enter Walk-In Right Curb Base Dimensions

### Measurements entered below are:

Stud-to-Stud (most common)  
(We will deduct 1/8" per wall for proper clearance)

Actual Size Needed  
Please remember that bases need 1/8" clearance per wall side  
(We will make exact as marked)

### Choose Curb Style

Full Height

Mid Height

Low Profile

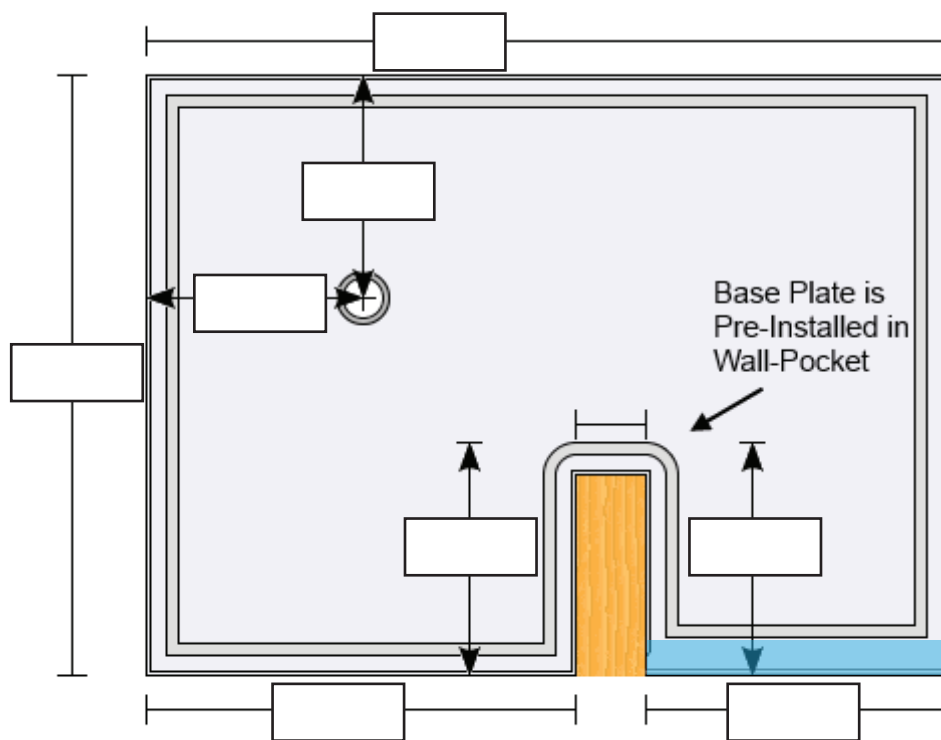

### Comments

### Your contact information:

Name:

Phone:

Email:

Zip:

To get a quote, contact an Onyx dealer

If you need help finding a dealer, download this  
form and email it to us at [info@onyxcollection.com](mailto:info@onyxcollection.com)